



OFFICE PROPERTIES



Office Building for Lease



4121 South Stream Drive

- Located beside LakePointe Corporate Park off Tyvola Road near the old Coliseum and near the Airport
- Approximately 3,538 rentable square feet.
- Large open area with perimeter offices, break area, storage area, working large vault, and customer walk in counters which can stay or be removed.
- \$24.00 NNN TICAM approximately \$4.50 psf
- Plenty of parking.
- Large build up of restaurants, hotels, and apartments beside and across the street.
- See layout next page.



Data presented on this flyer is secured from reliable sources and while every effort is made to obtain accuracy, it is not guaranteed as errors and omissions may occur.

John Stipp – Office Properties

8508 Park Road #131, Charlotte, NC 28210

(704) 540-1260

john@charlotteofficespace.com

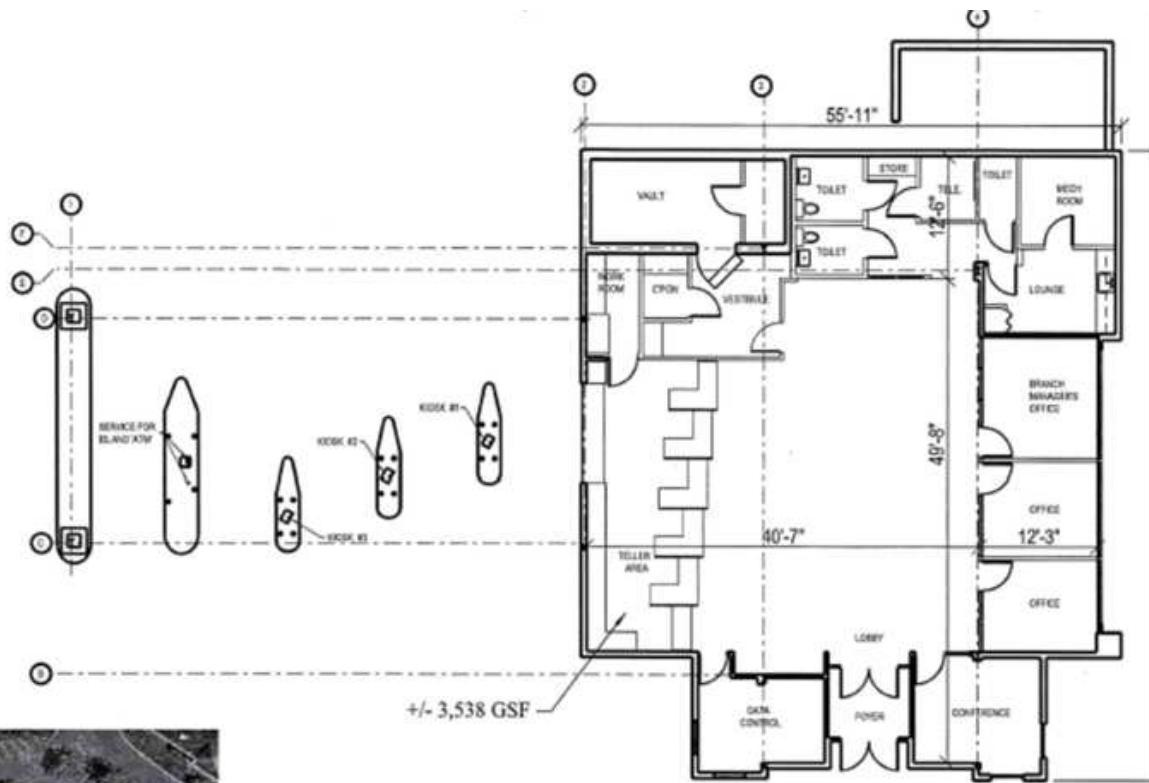

+/- 3,538 GSF

FLOOR PLAN - SCALE: 1/16" = 1'-0"



SITE PLAN